

SubConn® Micro Low Profile

7 and 9 contacts

Connector specifications

Voltage rating	300 V DC/AC rms
Current rating	5 A per contact (max 20 A per connector)
Insulation resistance	> 200 MΩ
Contact resistance	< 0.01 Ω
Wet matings	> 500
Temperature rating (water)	- 4 to 60°C, 25 to 140°F
Temperature rating (air)	- 40 to 60°C, - 40 to 140°F
Storage temperature rating	- 40 to 60°C, - 40 to 140°F
Qualified pressure tested	1,400 bar, 20,300 psi (mated) 800 bar, 11,600 psi (open face)
Depth rating PEEK	300 bar, 4,350 psi

Material specifications

Connector body	Chloroprene rubber
Bulkhead body	Brass, stainless steel, titanium, anodised aluminium or PEEK
Contacts	Female sockets in gold plated brass UNS - C36000 Male contacts in gold plated beryllium copper
O-rings	Nitrile
Locking strap	Chloroprene rubber
Inline cable (2 ft, 60 cm)	20 AWG, 0.52 mm ² synthetic rubber
Bulkhead leads (1 ft, 30 cm)	20 AWG, 0.52 mm ² coloured PTFE
OM leads (3", 7 cm)	20 AWG, 0.52 mm ² coloured PTFE

Face view (male)

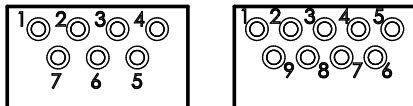

Inline cable colour code

1 Black	4 Green	7 White/black	10 Orange/black**
2 White	5 Orange	8 Red/black*	
3 Red	6 Blue	9 Green/black	

* Micro 7 contacts connector uses an 8 conductor cable (only 7 conductors are used)

** Micro 9 contacts connector uses a 10 conductor cable (only 9 conductors are used)

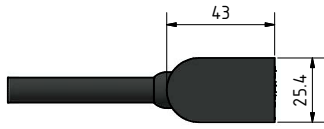

MCLPIL7F

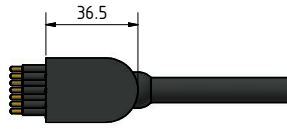

MCLPIL7M

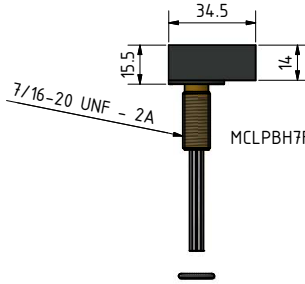
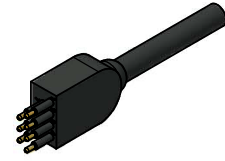

MCLPBH7F

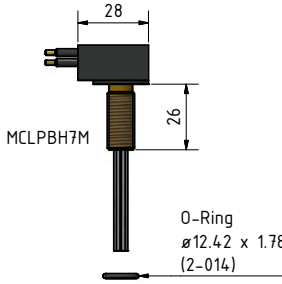

MCLPBH7M

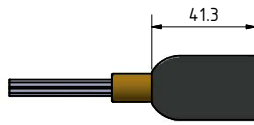
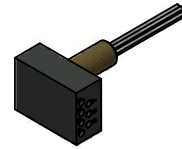

MCLPOM7F

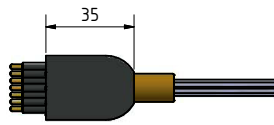

MCLPOM7M

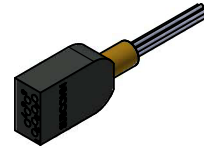

MCLPDC7F



MCLPDC7M

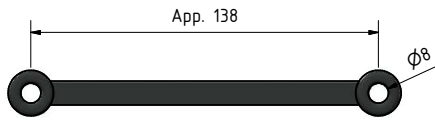
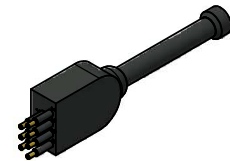

LPA Strap



Drawing information

Dimensions in mm (1 mm = 0.03937 inches)
Threads in inches (1 inch = 25.4 mm)

Cable and wire lead information

Synthetic rubber cables – see page 141. Wire leads – see page 142.
For recommended PUR cables, please refer to the Polyurethane cables section.