

# SubConn® Low Profile

## 2 contacts

### Connector specifications

Voltage rating	600 V DC/AC rms
Current rating	10 A per contact (max 20 A per connector)
Insulation resistance	> 200 MΩ
Contact resistance	< 0.01 Ω
Wet matings	> 500
Temperature rating (water)	- 4 to 60°C, 25 to 140°F
Temperature rating (air)	- 40 to 60°C, - 40 to 140°F
Storage temperature rating	- 40 to 60°C, - 40 to 140°F
Qualified pressure tested	1,400 bar, 20,300 psi (mated) 800 bar, 11,600 psi (open face)
Depth rating PEEK	300 bar, 4,350 psi

### Material specifications

Connector body	Chloroprene rubber
Bulkhead body	Brass, stainless steel, titanium, anodised aluminium or PEEK
Contacts	Gold plated brass UNS - C36000
Location pin	Stainless steel AISI 303
O-rings	Nitrile
Locking strap	Chloroprene rubber
Inline cable (2 ft, 60 cm)	16 AWG, 1.31 mm <sup>2</sup> synthetic rubber
Bulkhead leads (1 ft, 30 cm)	18 AWG, 0.82 mm <sup>2</sup> coloured ETFE
OM leads (3", 7 cm)	18 AWG, 0.82 mm <sup>2</sup> coloured ETFE

### Face view (male)

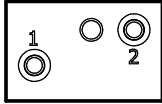

### Inline cable colour code

- 1 Black
- 2 White

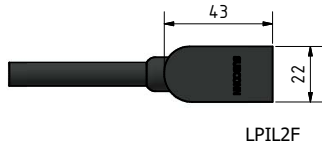

LPIL2F

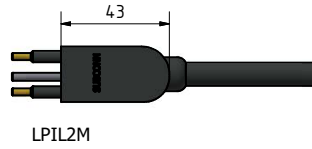

LPIL2M

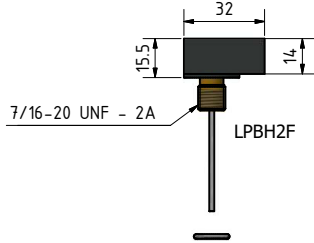
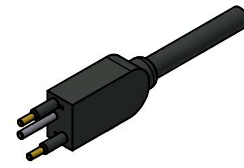

LPBH2F

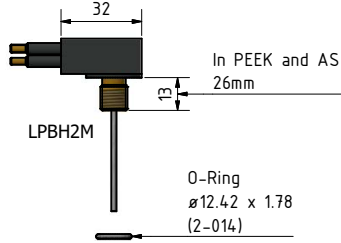

LPBH2M

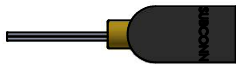
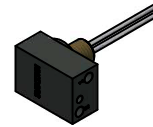

LPOM2F



LPOM2M

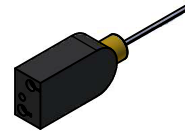

LPDC2F



LPDC2M

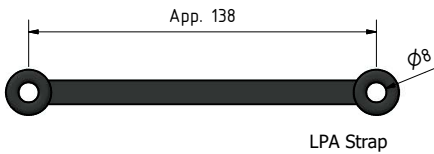
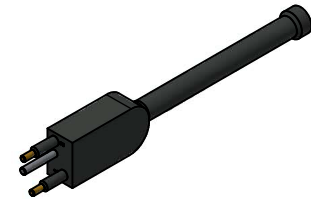

LPA Strap



**Drawing information**

Dimensions in mm (1 mm = 0.03937 inches)  
Threads in inches (1 inch = 25.4 mm)

**Cable and wire lead information**

Synthetic rubber cables – see page 141. Wire leads – see page 142.  
For recommended PUR cables, please refer to the Polyurethane cables section.