

# SubConn® Data Metal Shell 1500

## 9 contacts

### Connector specifications

Voltage rating	250 V DC/AC rms
Data rate	1 Gbit/s
Insulation resistance	> 200 MΩ
Contact resistance	< 0.01 Ω
Wet matings	> 500
Temperature rating (water)	- 4 to 60°C, 25 to 140°F
Temperature rating (air)	- 40 to 60°C, - 40 to 140°F
Storage temperature rating	- 40 to 60°C, - 40 to 140°F
Qualified pressure tested	600 bar, 8,700 psi (open face)

### Material specifications

Connector body	Chloroprene rubber
Connector housing	Stainless steel AISI 316 (other materials on request)
Contacts	Female sockets in gold plated brass UNS - C36000
	Male contacts in gold plated beryllium copper
O-rings	Nitrile
Connector leads (3.3 ft, 100 cm)	CAT 5E patch cable incl.
	Screened RJ 45 connector (not installed)

### Face view (male)

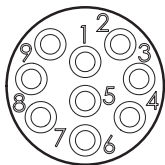

### Inline cable colour code

1-2 Brown, Brown/white*	7-8 Green, Green/white*
3-4 Blue, Blue/white*	9 Screen
5-6 Orange, Orange/white*	

\* Twisted pairs

### Additional information

Standard RJ45 cannot be mounted on inline cable and will require a RJ45 Phoenix connector or equivalent.



DMCIL9F

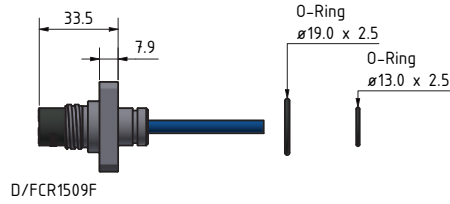

D/FCR1509F

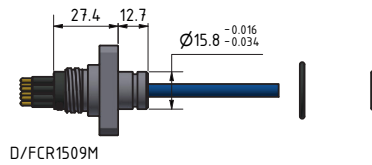
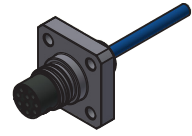

D/FCR1509M

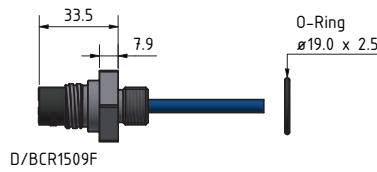
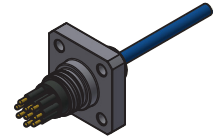

D/BCR1509F

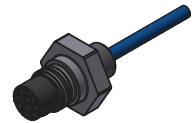

DMCIL9M

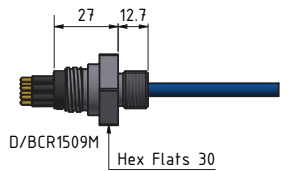

D/BCR1509M

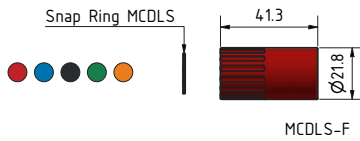
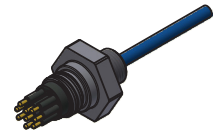

## Drawing information

Dimensions in mm (1 mm = 0.03937 inches)  
Threads in inches (1 inch = 25.4 mm)

## Cable and wire lead information

Synthetic rubber cables – see page 141. Wire leads – see page 142.  
For recommended PUR cables, please refer to the Polyurethane cables section.